

### Catalog Index:

Spherical roller bearings

Thrust spherical roller bearings

- Accuracy** Dimensional tolerance and geometrical accuracy is based on GB/T307.(ISO 492,DIN620)
- Material** Material for cylindrical roller is GCr15 (100 Cr6) bearing steel, quench-hardness HRC60---65.  
Material for inner and outer races is GCr15 (100 Cr6) bearing steel, quench-hardness HRC61---65.  
Available material for cages is stamping steel,brass,reinforced Nylon.
- CA** It's precision-machined brass cage and strengthened symmetric rollers, the designs are optimized to offer considerably higher load ratings than conventional designs for a broad range of application and long service life.
- CC** Two window-type steel cages, flangeless innerring and guide ring centred on the inner ring, symmetric roller, the designs are optimized.
- MB** It's 2 piece precision-machined brass cage. Improvement over the conventional design, these bearings incorporate strengthened symmetric rollers, and are equivalent to CC design in load capacity.
- K** Tapered bore, taper is 1: 12
- W30** Tapered bore, taper is 1: 30
- W33** With a lubricating groove and three lubricating holes in the outer ring.



### Spherical roller bearings

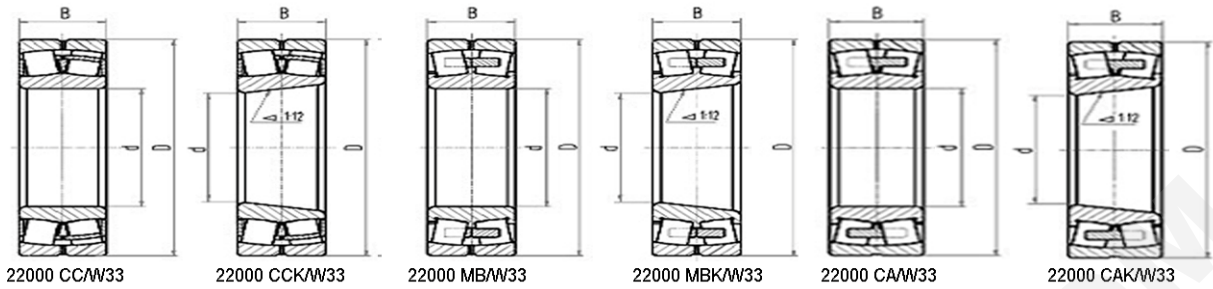

Bearing No.		Dimension (mm)			Shoulder (mm)			Load rating(KN)		Limiting speed		Mass	Original No.	
Cylindrical	Taper	d	D	B	da	Da	ra	Cr	Cor	grease	oil	(kg)	Cylindrical	Taper
21304 CA	21304 CAK	20	52	15	1.1	27	45	1	31.7	32.1	6000	7500	0.175	
22205 CC	22205 CCK	25	52	18	1	30	46	1	40	42	8000	10000	0.177	
22205 CA	22205 CAK		52	18	1	30	46	1	40	42	8000	10000	0.177	
21305 CA	21305 CAK		62	17	1.1	32	55	1	42.7	45.5	5300	6700	0.277	
22206 MB	22206 MBK	30	62	20	1	36	56	1	34.5	39.3	5300	6700	0.29	3506
22206 CA	22206 CAK		62	20	1	36	56	1	53.4	58.5	6300	8000	0.3	53506
22206 CC	22206 CCK		62	20	1	36	56	1	53.4	58.5	6700	8500	0.283	
21306 CA	21306 CAK		72	19	1.1	37	65	1	57.5	63.9	4500	6000	0.412	
22207 MB	22207 MBK	35	72	23	1.1	42	65	1	46.6	61.3	4800	6000	0.43	3507
22207 CA	22207 CAK		72	23	1.1	42	65	1	68.5	78.8	5300	6700	0.45	53507
22207 CC	22207 CCK		72	23	1.1	42	65	1	70.5	81.4	5600	7000	0.437	
21307 CA	21307 CAK		80	21	1.5	44	71	1.5	65.4	75.4	4000	5300	0.542	
22208 MB	22208 MBK	40	80	23	1.1	47	73	1	51.3	70.6	4500	5600	0.55	3508
22208 CA	22208 CAK		80	23	1.1	47	73	1	80.9	93.5	5000	6000	0.54	53508
22208 CC	22208 CCK		80	23	1.1	47	73	1	80.9	93.5	5000	6300	0.524	153508
21308 CA	21308 CAK		90	23	1.5	49	81	1.5	88.8	99	3600	4500	0.75	
21308 CC	21308 CCK		90	23	1.5	49	81	1.5	88.8	99	3600	4500	0.743	
22308 MB	22308 MBK		90	33	1.5	49	81	1.5	75.7	93.2	4000	5000	1.03	3608
22308 CA	22308 CAK		90	33	1.5	49	81	1.5	123.6	142.1	4300	5300	1	53608
22308 CC	22308 CCK		90	33	1.5	49	81	1.5	123.6	142.1	4500	6000	1.02	153608
22209 MB	22209 MBK	45	85	23	1.1	52	78	1	53.8	75.4	4000	5000	0.59	3509
22209 CA	22209 CAK		85	23	1.1	52	78	1	84.5	100.4	4500	5600	0.58	53509
22209 CC	22209 CCK		85	23	1.1	52	78	1	82.9	98	4500	6000	0.571	153509
21309 CA	21309 CAK		100	25	1.5	54	91	1.5	105.7	118.4	3200	4000	1.02	
21309 CC	21309 CCK		100	25	1.5	54	91	1.5	105.7	118.4	3200	4000	1	
22309 MB	22309 MBK		100	36	1.5	54	91	1.5	111.2	144.2	3600	4500	1.4	3609
22309 CA	22309 CAK		100	36	1.5	54	91	1.5	146.3	175.1	3800	4800	1.38	53609
22309 CC	22309 CCK		100	36	1.5	54	91	1.5	146.3	175.1	4000	5300	1.37	153609
22210 MB	22210 MBK	50	90	23	1.1	57	83	1	53.8	75.4	3800	4800	0.87	3510
22210 CA	22210 CAK		90	23	1.1	57	83	1	87	108.1	4000	5000	0.62	53510
22210 CC	22210 CCK		90	23	1.1	57	83	1	86.3	105.1	4300	5300	0.614	153510
21310 CA	21310 CAK		110	27	2	60	100	2	123.6	144.2	2800	3800	1.3	
21310 CC	21310 CCK		110	27	2	60	100	2	128.7	144.2	2800	3800	1.3	
22310 MB	22310 MBK		110	40	2	60	100	2	131.8	175.1	3400	4300	1.9	3610
22310 CA	22310 CAK		110	40	2	60	100	2	180.3	216.3	3400	4300	1.85	53610
22310 CC	22310 CCK		110	40	2	60	100	2	180.3	216.3	3800	4800	1.79	153610
22211 MB	22211 MBK	55	100	25	1.5	64	91	1.5	61.8	89.8	3400	4300	0.86	3511
22211 CA	22211 CAK		100	25	1.5	64	91	1.5	105.1	128.8	3600	4500	0.84	53511
22211 CC	22211 CCK		100	25	1.5	64	91	1.5	105.1	128.8	3800	5000	0.847	153511
21311 CA	21311 CAK		120	29	2	65	110	2	146.3	175.1	2600	3400	1.65	
21311 CC	21311 CCK		120	29	2	65	110	2	146.3	175.1	2600	3400	1.65	
22311 MB	22311 MBK		120	43	2	65	110	2	159.6	203.9	3000	3800	2.4	3611
22311 CA	22311 CAK		120	43	2	65	110	2	214.2	257.5	3000	3800	2.35	53611
22311 CC	22311 CCK		120	43	2	65	110	2	216.3	259.6	3400	4300	2.31	153611
22212 MB	22212 MBK	60	110	28	1.5	69	101	1.5	84.3	125.7	3200	4000	1.22	3512
22212 CA	22212 CAK		110	28	1.5	69	101	1.5	125.7	159.7	3200	4000	1.2	53512
22212 CC	22212 CCK		110	28	1.5	69	101	1.5	125.7	159.7	3600	4500	1.15	153512

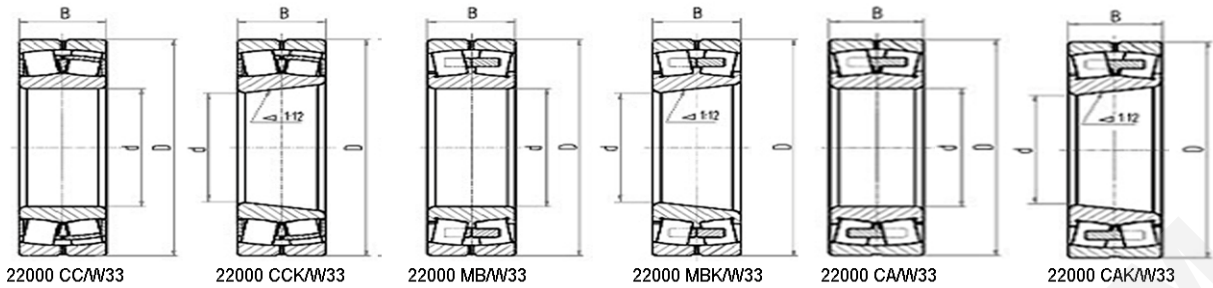

Bearing No.		Dimension (mm)			Shoulder (mm)			Load rating(KN)		Limiting speed		Mass	Original No.	
Cylindrical	Taper	d	D	B	da	Da	ra	Cr	Cor	grease	oil	(kg)	Cylindrical	Taper
21312 CA	21312 CAK		130	31	2.1	72	118	2.1	166.9	200.9	2400	3200	2.08	
21312 CC	21312 CCK		130	31	2.1	72	118	2.1	166.9	200.9	2400	3200	2.08	
22312 MB	22312 MBK		130	46	2.1	72	118	2.1	173	231.8	2800	3600	3	3612 113612
22312 CA	22312 CAK		130	46	2.1	72	118	2.1	245.1	293.6	2800	3600	2.95	53612 153612
22312 CC	22312 CCK		130	46	2.1	72	118	2.1	249.3	300.8	3200	4000	2.88	
22213 MB	22213 MBK	65	120	31	1.5	74	111	1.5	91.2	131.8	2800	3600	1.63	3513 113513
22213 CA	22213 CAK		120	31	1.5	74	111	1.5	154.5	200.8	2800	3600	1.6	53513 153513
22213 CC	22213 CCK		120	31	1.5	74	111	1.5	154.5	200.8	3200	4000	1.54	
21313 CA	21313 CAK		140	33	2.1	77	128	2.1	187.5	234.8	2200	3000	2.57	
21313 CC	21313 CCK		140	33	2.1	77	128	2.1	187.5	234.8	2200	3000	2.57	
22313 MB	22313 MBK		140	48	2.1	77	128	2.1	193.6	259.6	2400	3200	3.6	3613 113613
22313 CA	22313 CAK		140	48	2.1	77	128	2.1	267.8	324.4	2400	3200	3.55	53613 153613
22313 CC	22313 CCK		140	48	2.1	77	128	2.1	372.9	329.6	3000	3800	3.47	
22214 MB	22214 MBK	70	125	31	1.5	79	116	1.5	97.9	146.3	2600	3400	1.66	3514 113514
22214 CA	22214 CAK		125	31	1.5	79	116	1.5	162.7	211.2	2600	3400	1.7	53514 153514
22214 CC	22214 CCK		125	31	1.5	79	116	1.5	154.5	200.8	3000	3800	1.6	
21314 CA	21314 CAK		150	35	2.1	82	138	2.1	218.4	276	2000	2800	3.11	
21314 CC	21314 CCK		150	35	2.1	82	138	2.1	218.4	276	2000	2800	3.11	
22314 MB	22314 MBK		150	51	2.1	82	138	2.1	236.9	324.5	2200	3000	4.4	3614 113614
22314 CA	22314 CAK		150	51	2.1	82	138	2.1	300.8	372.9	2200	3000	4.4	53614 153614
22314 CC	22314 CCK		150	51	2.1	82	138	2.1	321.4	406.9	2800	3400	4.34	
22215 MB	22215 MBK	75	130	31	1.5	84	121	1.5	97.85	146.3	2400	3200	1.75	3515 113515
22215 CA	22215 CAK		130	31	1.5	84	121	1.5	166.9	221.5	2400	3200	1.8	53515 153515
22215 CC	22215 CCK		130	31	1.5	84	121	1.5	166.9	221.5	3000	3800	1.69	
21315 CA	21315 CAK		160	37	2.1	87	148	2.1	245.1	311.1	1900	2600	3.76	
21315 CC	21315 CCK		160	37	2.1	87	148	2.1	245.1	311.1	1900	2600	3.76	
22315 MB	22315 MBK		160	55	2.1	87	148	2.1	269.9	399.6	2000	2800	5.4	3615 113615
22315 CA	22315 CAK		160	55	2.1	87	148	2.1	352.3	451.1	2000	2800	5.25	53615 153615
22315 CC	22315 CCK		160	55	2.1	87	148	2.1	358.4	461.4	2600	3200	5.28	
22216 MB	22216 MBK	80	140	33	2	90	130	2	118.5	185.4	2200	3000	2.2	3516 113516
22216 CA	22216 CAK		140	33	2	90	130	2	180.3	245.1	2200	3000	2.2	53516 153516
22216 CC	22216 CCK		140	33	2	90	130	2	180.3	242.1	2800	3400	2.13	
21316 CA	21316 CAK		170	39	2.1	92	158	2.1	267.8	358.6	1800	2400	4.47	
21316 CC	21316 CCK		170	39	2.1	92	158	2.1	267.8	358.6	1800	2400	4.47	
22316 MB	22316 MBK		170	58	2.1	92	158	2.1	296.6	417.2	1900	2600	6.4	3616 113616
22316 CA	22316 CAK		170	58	2.1	92	158	2.1	396.6	512.9	1900	2600	6.39	53616 153616
22316 CC	22316 CCK		170	58	2.1	92	158	2.1	403.8	523.2	2400	3000	6.32	
22217 MB	22217 MBK	85	150	36	2	95	140	2	149.4	234.8	2000	2800	2.8	3517 113517
22217 CA	22217 CAK		150	36	2	95	140	2	216.3	286.3	2000	2800	2.7	53517 153517
22217 CC	22217 CCK		150	36	2	95	140	2	218.4	290.5	2600	3200	2.67	
21317 CA	21317 CAK		180	41	3	99	166	2.5	306.9	396.6	1700	2200	5.23	
21317 CC	21317 CCK		180	41	3	99	166	2.5	306.9	396.6	1700	2200	5.23	
22317 MB	22317 MBK		180	60	3	99	166	2.5	317.2	453.2	1800	2400	7.4	3617 113617
22317 CA	22317 CAK		180	60	3	99	166	2.5	432.6	556.2	1800	2400	7.25	53617 153617
22317 CC	22317 CCK		180	60	3	99	166	2.5	442.9	571.7	2200	2800	7.27	
22218 MB	22218 MBK	90	160	40	2	100	150	2	173	280.2	1900	2600	4	3518 113518
22218 CA	22218 CAK		160	40	2	100	150	2	247.2	331.7	1900	2600	3.28	53518 153518
22218 CC	22218 CCK		160	40	2	100	150	2	257.5	348.1	2400	3000	3.38	

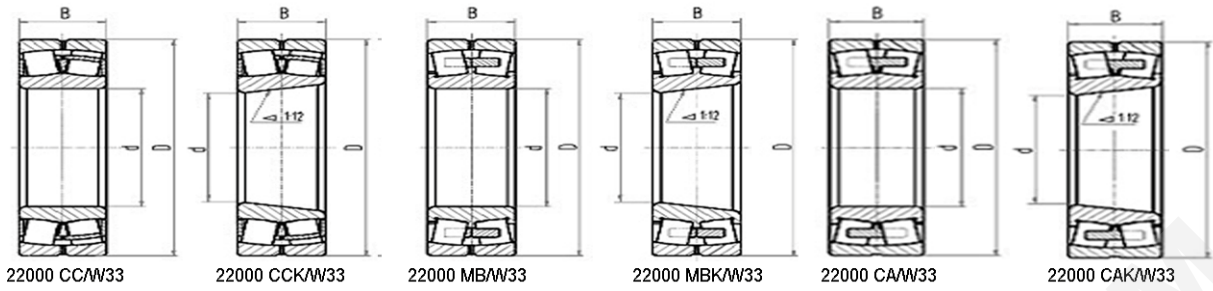

Bearing No.		Dimension (mm)			Shoulder (mm)			Load rating(KN)		Limiting speed		Mass	Original No.		
Cylindrical	Taper	d	D	B	da	Da	ra	Cr	Cor	grease	oil	(kg)	Cylindrical	Taper	
23218 CA	23218 CAK		160	52.4	2	100	150	2	334.7	492	1700	2200	4.6	3053218	3153218
23218 CC	23218 CCK		160	52.4	2	100	150	2	340	496.5	1800	2400	4.4		
21318 CA	21318 CAK		190	43	3	104	176	2.5	329.6	432.6	1600	2200	6.17		
21318 CC	21318 CCK		190	43	3	104	176	2.5	329.6	432.6	1600	2200	6.17		
22318 MB	22318 MBK		190	64	3	104	176	2.5	375.9	558.3	1700	2200	8.8	3618	113618
22318 CA	22318 CAK		190	64	3	104	176	2.5	489.3	640.7	1800	2400	8.6	53618	153618
22318 CC	22318 CCK		190	64	3	104	176	2.5	496.5	659.2	2200	2600	8.63		
22219 MB	22219 MBK	95	170	43	2.1	107	158	2.1	218.4	331.7	1800	2400	4.2	3519	113519
22219 CA	22219 CAK		170	43	2.1	107	158	2.1	286.3	391.4	1900	2600	4.1	53519	153519
22219 CC	22219 CCK		170	43	2.1	107	158	2.1	290.5	401.7	2200	2800	4.2		
21319 CA	21319 CAK		200	45	3	109	186	2.5	365.7	499.6	1700	2200	7.15		
21319 CC	21319 CCK		200	45	3	109	186	2.5	365.7	499.6	1700	2200	7.15		
22319 MB	22319 MBK		200	67	3	109	186	2.5	396.6	587.1	1600	2000	10.3	3619	113619
22319 CA	22319 CAK		200	67	3	109	186	2.5	535.6	708.6	1700	2200	10.1	53619	153619
22319 CC	22319 CCK		200	67	3	109	186	2.5	545.9	726.2	2000	2600	9.97		
23120 CA	23120 CAK	100	165	52	2	110	155	2	329.6	520.2	1600	2000	5	3053720	3153720
23120 CC	23120 CCK		165	52	2	110	155	2	331.7	525.3	1700	2200	4.31		
24020 CA			150	50	1.5	110	140	1.5	251	448	1200	1500	3.035		
24020 CC			150	50	1.5	110	140	1.5	260	461	1200	1500	3.035		
22220 MB	22220 MBK		180	46	2.1	112	168	2.1	228.7	368.7	1700	2200	5	3520	113520
22220 CA	22220 CAK		180	46	2.1	112	168	2.1	319.3	437.8	1800	2400	5	53520	153520
22220 CC	22220 CCK		180	46	2.1	112	168	2.1	324.5	448.1	2200	2600	5.01		
22220-95	22220-95K	95	180	46	2.1	112	168	2.1	325	448	2200	2600	5.21		
23220 CA	23220 CAK	100	180	60.3	2.1	112	168	2.1	427.5	636.5	1600	2000	6.7	3053220	3153220
23220 CC	23220 CCK		180	60.3	2.1	112	168	2.1	432.6	648.9	1600	2200	6.52		
21320 CA	21320 CAK		215	47	3	114	201	2.5	396.6	545.9	1600	2000	8.81		
21320 CC	21320 CCK		215	47	3	114	201	2.5	396.6	545.9	1600	2000	8.81		
22320 MB	22320 MBK		215	73	3	114	201	2.5	463.5	688	1400	1800	13	3620	113620
22320 CA	22320 CA		215	73	3	114	201	2.5	626.2	839.5	1400	1800	13.4	53620	153620
22320 CC	22320 CC		215	73	3	114	201	2.5	636.5	856.9	1900	2400	12.8		
23121 MB	23121 MBK	105	175	56	3	119	161	2.5	249	494	1400	1800	6.64	3003721	3113721
21321 CA	21321 CAK		225	49	3	119	211	2.5	420	575	1500	1900	10		
21321 CC	21321 CCK		225	49	3	119	211	2.5	420	575	1500	1900	10		
23022 MB	23022 MBK	110	170	45	2	120	160	2	201	422	1400	1800	3.9	3003122	3113122
23022 CA	23022 CAK		170	45	2	120	160	2	278	461	1500	1900	3.9	3053122	3153122
23022 CC	23022 CCK		170	45	2	120	160	2	280	466	1500	1900	3.68		
23122 MB	23122 MBK		180	56	2	120	170	2	270	489	1300	1700	6.1	3003722	3113722
23122 CA	23122 CAK		180	56	2	120	170	2	386	613	1300	1700	6.25	3053722	3153722
23122 CC	23122 CCK		180	56	2	120	170	2	389	620	1600	2000	5.51		
24122 CA	24122 CAK		180	69	2	120	170	2	472	798	1600	2000	6.63		
24122 CC	24122 CCK		180	69	2	120	170	2	472	798	1600	2000	6.63		
22222 MB	22222 MBK		200	53	2.1	122	188	2.1	297	479	1500	1900	7.4	3522	113522
22222 CA	22222 CAK		200	53	2.1	122	188	2.1	417	592	1700	2200	7.2	53522	153522
22222 CC	22222 CCK		200	53	2.1	122	188	2.1	422	606	1900	2400	7.32		
23222 CA	23222 CAK		200	69.8	2.1	122	188	2.1	530	809	1400	1800	9.7	3053222	3153222
23222 CC	23222 CCK		200	69.8	2.1	122	188	2.1	536	824	1500	1900	9.46		
21322 CA	21322 CAK		240	50	3	124	226	2.5	460	635	1400	1800	11.8		
21322 CC	21322 CCK		240	50	3	124	226	2.5	474	654	1400	1800	11.8		

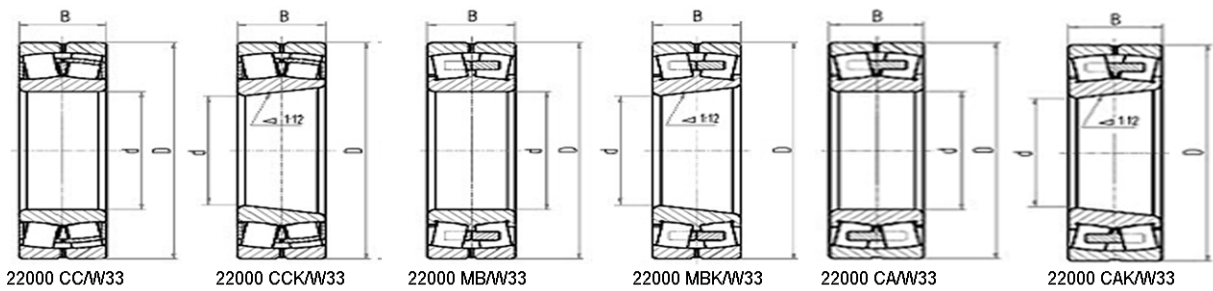

Bearing No.		Dimension (mm)			Shoulder (mm)			Load rating(KN)		Limiting speed		Mass	Original No.		
Cylindrical	Taper	d	D	B	da	Da	ra	Cr	Cor	grease	oil	(kg)	Cylindrical	Taper	
22322 MB	22322 MBK		240	80	3	124	226	2.5	561	857	1200	1600	18.1	3622	113622
22322 CA	22322 CAK		240	80	3	124	226	2.5	716	963	1500	1900	18	53622	153622
22322 CC	22322 CCK		240	80	3	124	226	2.5	736	997	1700	2200	17.5		
23024 MB	23024 MBK	120	180	46	2	130	170	2	218	484	1200	1600	4.3	3003124	3113124
23024 CA	23024 CAK		180	46	2	130	170	2	304	510	1400	1800	4.3	3053124	3153124
23024 CC	23024 CCK		180	46	2	130	170	2	309	515	1800	2200	3.98		
24024 CA	24024 CAK		180	60	2	130	170	2	380	675	1500	2000	5.05		
24024 CC	24024 CCK		180	60	2	130	170	2	391	695	1500	2000	5.05		
23124 MB	23124 MBK		200	62	2	130	190	2	299	589	1100	1500	7.63	3003724	3113724
23124 CA	23124 CAK		200	62	2	130	190	2	463	736	1300	1700	7.63	3053724	3153724
23124 CC	23124 CCK		200	62	2	130	190	2	463	744	1400	1800	7.67		
24124 CA	24124 CAK		200	80	2	130	190	2	575	998	1400	1800	9.65		
24124 CC	24124 CCK		200	80	2	130	190	2	592	1028	1400	1800	9.65		
22224 MB	22224 MBK		215	58	2.1	132	203	2.1	352	582	1300	1700	9.2	3524	113524
22224 CA	22224 CAK		215	58	2.1	132	203	2.1	484	698	1600	2000	9	53524	153524
22224 CC	22224 CCK		215	58	2.1	132	203	2.1	494	711	1700	2200	9.1		
23224 CA	23224 CAK		215	76	2.1	132	203	2.1	620	968	1300	1700	12	3053224	3153224
23224 CC	23224 CCK		215	76	2.1	132	203	2.1	628	984	1300	1700	11.7		
22324 MB	22324 MBK		260	86	3	134	246	2.5	664	1022	1100	1500	22	3624	113624
22324 CA	22324 CAK		260	86	3	134	246	2.5	847	1154	1300	1700	22	53624	153624
22324 CC	22324 CCK		260	86	3	134	246	2.5	870	1195	1500	1900	22.2		
23026 MB	23026 MBK	130	200	52	2	140	190	2	278	626	1100	1500	6.2	3003126	3113126
23026 CA	23026 CAK		200	52	2	140	190	2	383	644	1200	1600	6.2	3053126	3153126
23026 CC	23026 CCK		200	52	2	140	190	2	386	649	1700	2000	5.85		
24026 CA	24026 CAK		200	69	2	140	190	2	472	852	1400	1800	7.55		
24026 CC	24026 CCK		200	69	2	140	190	2	486	878	1400	1800	7.55		
23126 CA	23126 CAK		210	64	2	140	200	2	492	812	1300	1700	8.49	3053726	3153726
23126 CC	23126 CCK		210	64	2	140	200	2	496	826	1300	1700	8.49		
24126 CA	24126 CAK		210	80	2	140	200	2	585	1030	1200	1600	10.3		
24126 CC	24126 CCK		210	80	2	140	200	2	603	1061	1300	1700	10.3		
22226 MB	22226 MBK		230	64	3	144	216	2.5	420	729	1200	1600	11.2	3526	113526
22226 CA	22226 CAK		230	64	3	144	216	2.5	567	834	1400	1800	11.2	53526	153526
22226 CC	22226 CCK		230	64	3	144	216	2.5	579	857	1600	2000	11.2		
23226 CA	23226 CAK		230	80	3	144	216	2.5	708	1092	1200	1600	14	3053226	3153226
23226 CC	23226 CCK		230	80	3	144	216	2.5	698	1112	1200	1600	13.8		
22326 MB	22326 MBK		280	93	4	148	262	3	744	1170	950	1300	29	3626	113626
22326 CA	22326 CAK		280	93	4	148	262	3	970	1340	1200	1600	28.5	53626	153626
22326 CC	22326 CCK		280	93	4	148	262	3	994	1380	1400	1800	27.5		
23028 MB	23028 MBK	140	210	53	2	150	200	2	294	654	950	1300	6.7	3003128	3113128
23028 CA	23028 CAK		210	53	2	150	200	2	414	719	1100	1500	6.7	3053128	3153128
23028 CC	23028 CCK		210	53	2	150	200	2	420	720	1600	1900	6.31		
24028 CA	24028 CAK		210	69	2	150	200	2	488	895	1200	1600	8.01		
24028 CC	24028 CCK		210	69	2	150	200	2	503	922	1300	1700	8.01		
23128 MB	23128 MBK		225	68	2.1	152	213	2.1	410	623	950	1300	10.9	3003728	3113728
23128 CA	23128 CAK		225	68	2.1	152	213	2.1	561	953	1100	1500	10.9	3053728	3153728
23128 CC	23128 CCK		225	68	2.1	152	213	2.1	554	932	1200	1600	10.2		
24128 CA	24128 CAK		225	85	2.1	152	213	2.1	670	1200	1100	1500	12.5		
22228 MB	22228 MBK		250	68	3	154	236	2.5	492	829	1000	1400	14.5	3528	113528

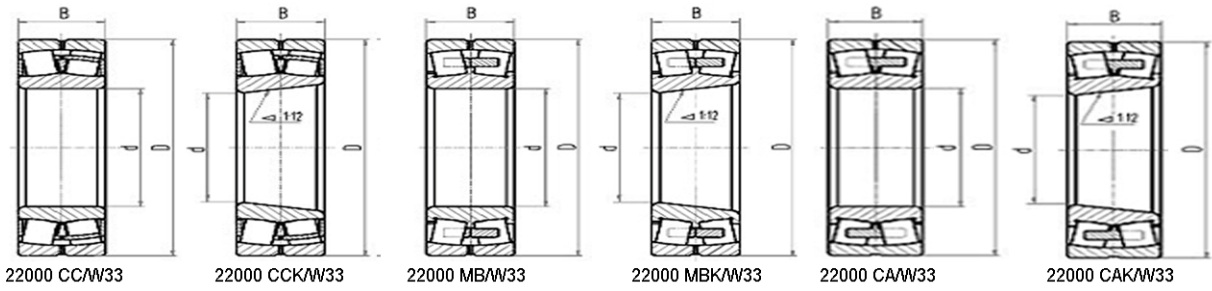

Bearing No.		Dimension (mm)			Shoulder (mm)			Load rating(KN)		Limiting speed		Mass	Original No.		
Cylindrical	Taper	d	D	B	da	Da	ra	Cr	Cor	grease	oil	(kg)	Cylindrical	Taper	
22228 CA	22228 CAK		250	68	3	154	236	2.5	647	958	1300	1700	14.5	53528	153528
22228 CC	22228 CCK		250	68	3	154	236	2.5	659	984	1400	1700	14.2		
23228 CA	23228 CAK		250	88	3	154	236	2.5	826	1320	1000	1400	18.5	3053228	3153228
23228 CC	23228 CCK		250	88	3	154	236	2.5	836	1340	1100	1500	18.1		
22328 MB	22328 MBK		300	102	4	158	282	3	850	1380	900	1200	36	3628	113628
22328 CA	22328 CAK		300	102	4	158	282	3	1140	1620	1100	1500	34.5	53628	153628
22328 CC	22328 CCK		300	102	4	158	282	3	1164	1660	1300	1700	34.6		
23030 MB	23030 MBK	150	225	56	2.1	162	213	2.1	338	790	900	1200	8.14	3003130	3113130
23030 CA	23030 CAK		225	56	2.1	162	213	2.1	451	790	1100	1400	8.14	3053130	3153130
24030 CA	24030 CAK		225	75	2.1	162	213	2.1	570	1070	1100	1400	10.6		
23130 MB	23130 MBK		250	80	2.1	162	238	2.1	527	1110	850	1100	16.1	3003730	3113730
23130 CA	23130 CAK		250	80	2.1	162	238	2.1	747	1267	1000	1300	16.1	3053730	3153730
24130 CA	24130 CAK		250	100	2.1	162	238	2.1	890	1600	1000	1300	19		
22230 MB	22230 MBK		270	73	3	164	256	2.5	523	900	950	1300	18.5	3530	113530
22230 CA	22230 CAK		270	73	3	164	256	2.5	760	1130	1200	1600	18.6	53530	153530
22230 CC	22230 CCK		270	73	3	164	256	2.5	772	1164	1300	1600	18		
23230 CA	23230 CAK		270	96	3	164	256	2.5	963	1560	950	1300	24	3053230	3153230
22330 MB	22330 MBK		320	108	4	168	302	3	1050	1790	850	1100	43	3630	113630
22330 CA	22330 CAK		320	108	4	168	302	3	1270	1850	1100	1400	42.5		
23032 MB	23032 MBK	160	240	60	2.1	172	228	2.1	379	850	850	1100	10	3003132	3113132
23032 CA	23032 CAK		240	60	2.1	172	228	2.1	515	900	1000	1300	10	3053132	3153132
24032 CA	24032 CAK		240	80	2.1	172	228	2.1	652	1230	1000	1300	12.2		
23132 MB	23132 MBK		270	86	2.1	172	258	2.1	536	1140	800	1000	19.7	3003732	3113732
23132 CA	23132 CAK		270	86	2.1	172	258	2.1	870	1460	900	1200	19.7	3053732	3153732
24132 CA	24132 CAK		270	109	2.1	172	258	2.1	1040	1880	900	1200	24.6		
22232 MB	22232 MBK		290	80	3	174	276	2.5	660	1170	900	1200	22.2	3532	113532
22232 CA	22232 CAK		290	80	3	174	276	2.5	850	1280	1000	1400	23.1	53532	153532
23232 CA	23232 CAK		290	104	3	174	276	2.5	1112	1810	900	1200	30	3053232	3153232
22332 MB	22332 MBK		340	114	4	178	322	3	1070	1820	800	1000	51	3632	113632
23034 MB	23034 MBK	170	260	67	2.1	182	248	2.1	458	1040	800	1000	13	3003134	3113134
23034 CA	23034 CAK		260	67	2.1	182	248	2.1	626	1112	900	1200	13	3053134	3153134
24034 CA	24034 CAK		260	90	2.1	182	248	2.1	792	1520	900	1200	16.7		
23134 CA	23134 CAK		280	88	2.1	182	268	2.1	911	1565	850	1100	21.1	3053734	3153734
24134 CA	24134 CAK		280	109	2.1	182	268	2.1	1070	1930	900	1200	25.5		
22234 MB	22234 MBK		310	86	4	188	292	3	740	1330	850	1100	29	3534	113534
22234 CA	22234 CAK		310	86	4	188	292	3	975	1500	950	1200	29		
23234 CA	23234 CAK		310	110	4	188	292	3	1200	2030	800	1100	35.7		
22334 MB	22334 MBK		360	120	4	188	342	3	1180	2120	750	950	60	3634	113634
23036 MB	23036 MBK	180	280	74	2.1	192	268	2.1	556	1260	750	950	17.6	3003136	3113136
23036 CA	23036 CAK		280	74	2.1	192	268	2.1	730	1290	800	1000	17.6	3053136	3153136
23036 CC	23036 CCK		280	74	2.1	192	268	2.1	740	1350	1200	1400	16.9		
24036 CA	24036 CAK		280	100	2.1	192	268	2.1	928	1820	800	1000	22.1		
24036 CC	24036 CCK		280	100	2.1	192	268	2.1	955	1870	950	1200	22.1		
23136 CA	23136 CAK		300	96	3	194	286	2.5	1060	1850	800	1000	27.1	3053736	3153736
23136 CA	23136 CAK		300	96	3	194	286	2.5	1080	1880	900	1200	26.9		
24136 CA	24136 CAK		300	118	3	194	286	2.5	1210	2220	800	1000	32		
22236 MB	22236 MBK		320	86	4	198	302	3	757	1410	800	1000	30	3536	113536
22236 CA	22236 CAK		320	86	4	198	302	3	1010	1590	900	1100	30		

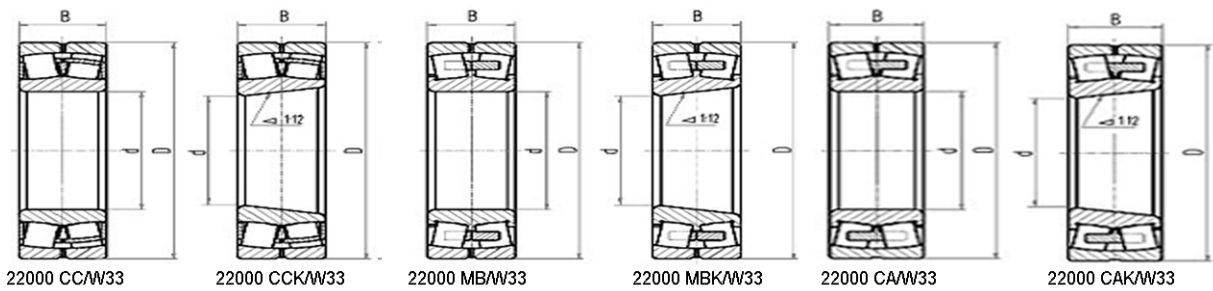

Bearing No.		Dimension (mm)				Shoulder (mm)			Load rating(KN)		Limiting speed		Mass	Original No.	
Cylindrical	Taper	d	D	B		da	Da	ra	Cr	Cor	grease	oil	(kg)	Cylindrical	Taper
22236 CA	22236 CAK		320	86	4	198	302	3	1040	1630	1100	1300	29.4		
23236 CA	23236 CAK		320	112	4	198	302	3	1280	2170	1000	1200	37.9		
22336 MB	22336 MBK		380	126	4	198	362	3	1290	2330	700	900	70	3636	113636
23936 CA	23936 CAK		250	52	2	190	240	2	435	836	1650	2250	7.35		
23038 MB	23038 MBK	190	290	75	2.1	202	278	2.1	570	1260	700	900	20	3003138	3113138
23038 CA	23038 CAK		290	75	2.1	202	278	2.1	767	1390	800	1000	20	3053138	3153138
24038 CA	24038 CAK		290	100	2.1	202	278	2.1	975	1910	800	1100	23		
23138 MB	23138 MBK		320	104	3	204	306	2.5	811	1880	670	850	35.3	3003738	3113738
23138 CA	23138 CAK		320	104	3	204	306	2.5	1200	2120	750	1000	35.3		
24138 CA	24138 CAK		320	128	3	204	306	2.5	1410	2590	700	1000	40.2		
22238 MB	22238 MBK		340	92	4	208	322	3	842	1555	750	950	35.3	3538	113538
23238 CA	23238 CAK		340	120	4	208	322	3	1450	2490	700	1000	46.1		
23238 CA	23238 CAK		340	120	4	208	322	3	1490	2550	800	1100	46.1		
22338 MB	22338 MBK		400	132	5	212	378	4	1430	2600	670	850	81	3638	113638
23940 CA	23940 CAK		280	60	2.1	212	268	2	490	1160	1650	2050	12.1		
23040 MB	23040 MBK	200	310	82	2.1	212	298	2.1	597	1340	670	850	24	3003140	3113140
23040 CA	23040 CAK		310	82	2.1	212	298	2.1	890	1650	900	1100	24		
23040 CC	23040 CCK		310	82	2.1	212	298	2.1	916	1690	1000	1300	22.7		
24040 CA	24040 CAK		310	109	2.1	212	298	2.1	1120	2220	670	850	29.3		
23140 MB	23140 MBK		340	112	3	214	326	2.5	937	2070	630	800	50.7	3003740	3113740
23140 CA	23140 CAK		340	112	3	214	326	2.5	1420	2530	800	1000	47.6		
24140 MB	24140 MBK		340	140	3	214	326	2.5	1480	2550	700	900	49.55		
24140 CA	24140 CAK		340	140	3	214	326	2.5	1620	3030	800	1000	49.9		
22240 MB	22240 MBK		360	98	4	218	342	3	947	1790	700	900	47.7	3540	113540
23240 CA	23240 CAK		360	128	4	218	342	3	1650	2870	750	1000	55.4		
22340 MB	22340 MBK		420	138	5	222	398	4	1530	2800	630	800	94	3640	113640
23044 MB	23044 MBK	220	340	90	3	234	326	2.5	783	1860	600	750	28.8	3003144	3113144
23044 CA	23044 CAK		340	90	3	234	326	2.5	1090	2040	950	1200	29.7		
24044 CA	24044 CAK		340	118	3	234	326	2.5	1370	2760	750	1000	38.1		
23144 MB	23144 MBK		370	120	4	238	352	3	1060	2420	600	750	55	3003744	3113744
23144 CA	23144 CAK		370	120	4	238	352	3	1610	2900	700	950	51.5		
24144 CA	24144 CAK		370	150	4	238	352	3	1900	3580	700	950	62.3		
22244 MB	22244 MBK		400	108	4	238	382	3	1200	2280	630	800	61.5	3544	113544
23244 CA	23244 CAK		400	144	4	238	382	3	2130	3720	670	900	78.5		
22344 MB	22344 MBK		460	145	5	242	438	4	1740	3290	560	700	120	3644	113644
23048 MB	23048 MBK	240	360	92	3	254	346	2.5	816	2120	530	670	35.5	3003148	3113148
23048 CA	23048 CAK		360	92	3	254	346	2.5	1160	2220	850	1100	32.4		
24048 CA	24048 CAK		360	118	3	254	346	2.5	1440	2930	700	950	40.8		
23148 MB	23148 MBK		400	128	4	258	382	3	1230	2910	500	630	55.5	3003748	3113748
23148 CA	23148 CAK		400	128	4	258	382	3	1840	3310	670	850	63.7		
24148 CA	24148 CAK		400	160	4	258	382	3	2160	4090	670	850	76.9		
23248 CA	23248 CAK		440	160	4	258	422	3	2560	4620	630	800	107.3		
22348 MB	22348 MBK		500	155	5	262	478	4	1780	3340	500	630	153	3648	113648
23948 CA	23948 CAK		320	60	2.1	252	308	2	540	1320	1250	1750	14.95		
23052 MB	23052 MBK	260	400	104	4	278	382	3	1030	2520	500	630	515	3003152	3113152
23052 CA	23052 CAK		400	104	4	278	382	3	1460	2850	800	950	47.7		
24052 CA	24052 CAK		400	140	4	278	382	3	1840	3850	630	850	62.4		
23152 MB	23152 MBK		440	144	4	278	422	3	1470	3410	450	560	95.3	3003752	3113752

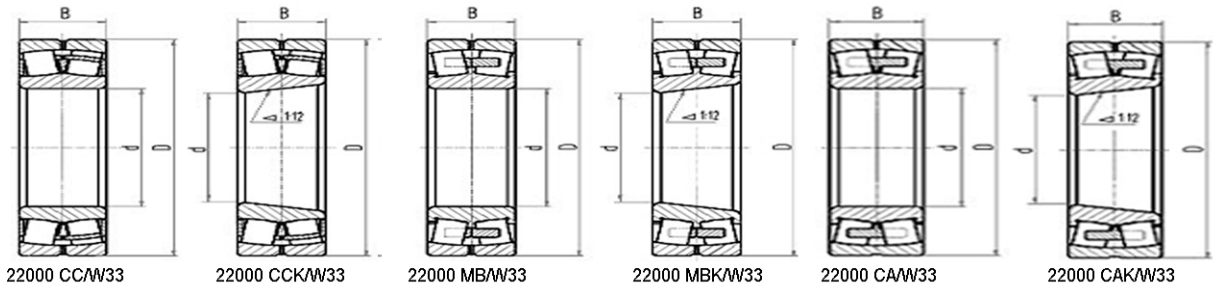

Bearing No.		Dimension (mm)			Shoulder (mm)			Load rating(KN)		Limiting speed		Mass	Original No.		
Cylindrical	Taper	d	D	B	da	Da	ra	Cr	Cor	grease	oil	(kg)	Cylindrical	Taper	
23152 CA	23152 CAK		440	144	4	278	422	3	2270	4190	600	800	88.2		
24152 CA	24152 CAK		440	180	4	278	422	3	2730	5330	600	800	107.6		
22352 MB	22352 MBK		540	165	6	288	512	5	2260	4310	480	600	191	3652	113652
23952 CA	23952 CAK		360	75	2.1	272	348	2	820	1750	1150	1550	21.65		
23056 MB	23056 MBK	280	420	106	4	298	402	3	1110	2760	450	560	62	3003156	3113156
23056 CA	23056 CAK		420	106	4	298	402	3	1580	3030	700	900	50.9		
24056 CC	24056 CCK		420	140	4	298	402	3	1960	4100	600	800	65.8		
23156 CA	23156 CAK		460	146	5	302	438	4	2380	4410	560	750	94.1		
24156 CA	24156 CAK		460	180	5	302	438	4	2810	5480	560	750	113.2		
22256 CA	22256 CAK		500	130	5	302	478	4	1740	3480	500	630	112.3	3556	113556
22356 CA	22356 CAK		580	175	6	308	552	5	2490	4780	450	560	238	3656	113656
23956 CA	23956 CAK		380	75	2.1	292	368	2	710	1860	1050	1350	25.67		
23060 CA	23060 CAK	300	460	118	4	318	442	3	1910	3800	670	850	71.4		
24060 CA	24060 CAK		460	160	4	318	442	3	2430	5160	530	700	94.1		
23160 CA	23160 CAK		500	160	5	322	478	4	1990	4550	400	500	133	3003760	3113760
22260 CA	22260 CAK		540	140	5	322	518	4	1895	3550	450	560	134	3560	113560
23260 CA	23260 CAK		540	192	5	322	518	4	3200	5500	540	680	191.85		
23960 CA	23960 CAK		420	90	3	314	406	2.5	1060	2540	940	1400	40.15		
22264 CA	22264 CAK	320	580	150	5	342	558	4	2500	4560	680	860	175		
23064 CA	23064 CAK		480	121	4	338	462	3	1940	2150	810	1100	85		
24064 CA	24064 CAK		480	160	4	338	462	3	2500	5150	550	650	105.85		
23164 CA	23164 CAK		540	176	5	342	518	4	3200	3350	640	790	198		
23264 CA	23264 CAK		580	208	5	342	558	4	3900	6800	500	640	254.5		
23068 CA	23068 CAK	340	520	133	5	362	498	4	2000	4500	750	950	115.55		
23168 CA	23168 CAK		580	190	5	362	558	4	3100	6400	610	760	205.98		
24068 CA	24068 CAK		520	180	5	362	498	4	2500	5680	540	680	138.5		
23968 CA	23968 CAK		460	90	3	354	446	2.5	1200	2700	950	1250	46		
23072 CA	23072 CAK	360	540	134	5	382	518	4	2280	4900	680	860	126.65		
23172 CA	23172 CAK		600	192	5	382	578	4	3300	6900	550	710	256		
24172 CA	24172 CAK		600	243	5	382	578	4	5550	8400	310	380	270		
22372 CA	22372 CAK		750	224	7.5	392	720	6	5000	8700	410	510	465		
23272 CA	23272 CAK		650	232	6	388	622	5	4600	8250	400	500	332		
23972 CA	23972 CAK		480	90	3	374	466	2.5	1290	2820	860	1150	47		
23076 CA	23076 CAK	380	560	135	5	402	538	4	2500	5000	640	850	132		
24076 CA	24076 CAK		560	180	5	402	538	4	3200	6950	480	590	153		
23176 CA	23176 CAK		620	194	5	402	598	4	3400	7400	410	510	245		
23976 CA	23976 CAK		520	106	4	398	502	3	1740	3850	800	1000	69.8		
23080 CA	23080 CAK	400	600	148	5	422	578	4	2550	5900	600	750	162		
24080 CA	24080 CAK		600	200	5	422	578	4	3600	7850	450	560	202		
23180 CA	23180 CAK		650	200	6	428	622	5	4120	7660	390	490	274		
23280 CA	23280 CAK		720	256	6	428	692	5	6200	11300	350	440	354		
23980 CA	23980 CAK		540	106	4	418	522	3	1740	3900	760	960	73		
23084 CA	23084 CAK	420	620	150	5	442	598	4	2700	6450	460	550	150		
24084 CA	24084 CAK		620	200	5	442	598	4	3400	8500	220	400	200		
23184 CA	23184 CAK		700	224	6	448	672	5	3700	5200	360	460	354		
23284 CA	23284 CAK		760	272	7.5	456	724	6	5600	12000	330	410	550		
23088 CA	23088 CAK	440	650	157	6	468	622	5	2800	6500	430	530	186		
23188 CA	23188 CAK		720	226	6	468	692	5	4500	10500	350	440	378		

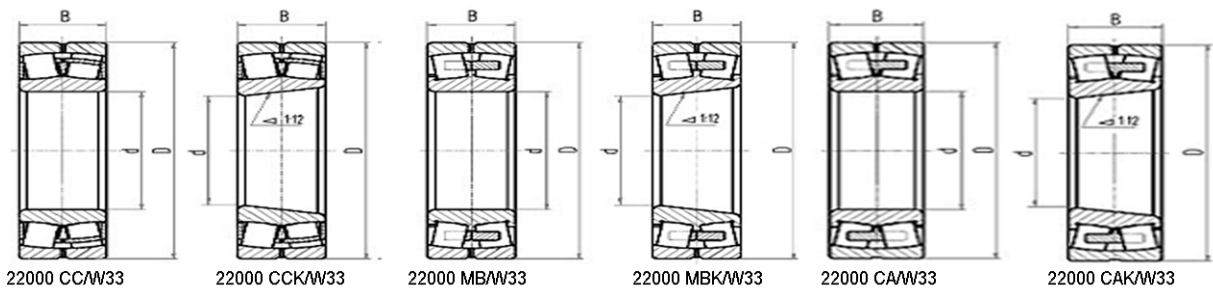

Bearing No.		Dimension (mm)			Shoulder (mm)			Load rating(KN)		Limiting speed		Mass	Original No.		
Cylindrical	Taper	d	D	B	da	Da	ra	Cr	Cor	grease	oil	(kg)	Cylindrical	Taper	
23092 CA	23092 CAK	460	680	163	6	488	652	5	3500	7000	400	500	228		
24092 CA	24092 CAK		680	218	6	488	652	5	4250	9150	350	440	305		
24192 CA	24192 CAK		760	300	7.5	496	724	6	6150	1450	170	210	459		
23192 CA	23192 CAK		760	240	7.5	496	724	6	5500	10500	330	410	459		
23292 CA	23292 CAK		830	296	7.5	496	794	6	7400	14000	300	380	700		
23196 CA	23196 CAK	480	790	248	7.5	516	754	6	6100	12000	300	380	516		
23296 CA	23296 CAK		870	310	7.5	516	834	6	6800	15000	260	350	855		
23996 CA	23996 CAK		650	128	5	501	628	4	2200	5800	410	510	61		
230/500 CA	230/500 CAK	500	720	167	6	528	692	5	3200	7600	380	480	228		
232/500 CA	232/500 CAK		920	336	7.5	536	884	6	8600	18700	295	370	988		
239/500 CA	239/500 CAK		670	118	5	522	648	4	2540	6000	410	500	125		
230/530 CA	230/530 CAK	530	780	185	6	558	752	5	4000	10000	350	450	338		
230/560 CA	230/560 CAK	560	820	195	6	588	792	5	4300	10500	330	410	365		
231/560 CA	231/560 CAK		920	280	7.5	596	884	6	7000	15900	240	330	746		
239/560 CA	239/560 CAK		750	140	5	582	728	4	3100	7250	340	440	178		
230/600 CA	230/600 CAK	600	870	200	6	628	842	5	4700	11600	310	390	445		
241/600 CA	241/600 CAK		980	375	7.5	636	944	6	8800	21700	110	160	1145		
230/630 CA	230/630 CAK	630	920	212	7.5	666	884	6	5160	13000	270	350	475		
230/670 CA	230/670 CAK	670	980	230	7.5	706	944	6	5740	14300	250	330	605		
230/750 CA	230/750 CAK	750	1090	250	7.5	786	1054	6	7000	18000	210	270	790		

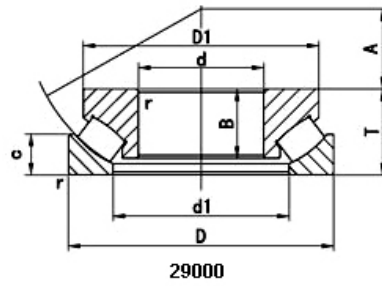

**Thrust spherical roller bearings**

Bearing No.		Dimension (mm)									Load rating (KN)		Limit speed		Mass
New	Original	d	D	H	B	C	a	D1	d1	rsmin	Ca	Coa	grease	oil	(kg)
29412 EM	9039412	60	130	42	15	20.1	38	117.7	86	1.5	364.5	967.2	1650	2200	2.75
29413 EM	9039413	65	140	45	16	21.3	42	126.8	93	2	418.2	1126	1550	2200	3.41
29414 EM	9039414	70	150	48	17	22.7	44	136.3	99.5	2	467	1344	1450	2000	4.1
29415 EM	9039415	75	160	51	18	24.3	47	145.8	106	2	546	1522	1450	1800	4.98
29416 EM	9039416	80	170	54	19	26.8	50	154.1	113	2.1	610	1722	1450	1800	5.95
29317 EM	9039317	85	150	39	13	18.7	50	137.9	111	1.5	300	1050	1500	2000	2.87
29417 EM	9039417	85	180	58	21	27.3	54	162.1	121	2.1	653	1815	1200	1600	7.19
29318 EM	9039318	90	155	39	13	17.9	52	143.3	117.5	1.5	370	1139	1500	2000	3.06
29418 EM	9039418	90	190	60	22	28.5	56	172	128	2.1	747	2147	1200	1600	8.28
29320 EM	9039320	100	170	42	14	20.5	58	158	127.5	1.5	440	1400	1400	1800	3.91
29420 EM	9039420	100	210	67	24	32.4	62	190	141.5	3	883	2552	1000	1400	11.2
29322 EM	9039322	110	190	48	16	22.1	64	177	144	2	542	1740	1200	1600	5.67
29422 EM	9039422	110	230	73	26	34.5	69	209.1	153.5	3	1048	3079	900	1200	14.7
29324 EM	9039324	120	210	54	18	25.9	70	194.4	156	2.1	685	2230	1000	1400	7.96
29424 EM	9039424	120	250	78	28	36.6	74	225.4	170	4	1191	3566	900	1200	18.5
29326 EM	9039326	130	225	58	19	27.8	76	208.7	168	2.1	770	2520	900	1400	9.45
29426 EM	9039426	130	270	85	31	39.7	81	243.5	182.5	4	1382	4160	780	1100	23.6
29328 EM	9039328	140	240	60	20	28.9	82	221.4	181	2.1	868	2940	850	1200	11.2
29428 EM	9039428	140	280	85	31	39.8	86	254.1	194	4	1433	4436	780	1000	24.6
29330 EM	9039330	150	250	60	20	29.8	87	232	191.5	2.1	884	3065	850	1200	11.7
29430 EM	9039430	150	300	90	32	42.1	92	271.3	209.5	4	1624	5111	700	1000	29.6
29332 EM	9039332	160	270	67	23	31.7	92	250.5	205	3	1021	3486	800	1100	15.5
29432 EM	9039432	160	320	95	34	47.1	99	292.2	219	5	1750	5330	680	900	35.9
29334 EM	9039334	170	280	67	23	31.4	96	260.2	216.5	3	1044	3644	800	1000	16.3
29434 EM	9039434	170	340	103	37	48.6	104	309.2	234	5	2062	6585	630	850	44
29236 EM	9039236	180	250	42	15	21.3	97	239	209	1.5	420	2010	750	1300	7.05
29336 EM	9039336	180	300	73	25	34.6	103	278.4	227.5	3	1244	4387	1000		20.7
29436 EM	9039436	180	360	109	39	51.9	110	327.5	249.5	5	2275	7317	1760	5500	52.2
29238 EM	9039238	190	270	48	15	24	103	254	224	2	518	2460	1300		7.95
29338 EM	9039338	190	320	78	27	38.6	110	298.5	240.5	4	1398	4955	580	760	25.5
29438 EM	9039438	190	380	115	41	54.9	117	345.3	262	5	2527	8205	750	800	61.4
29240 EM	9039240	200	280	48	15	24	108	271	236	2	546	2518	1300		9.08
29340 EM	9039340	200	340	85	29	39.1	116	315.6	259	4	1582	5566	650	800	32
29440 EM	9039440	200	400	122	44	57.5	122	363.2	278	5	2785	9070	550	760	73
29244 EM	9039244	220	300	48	15	23	117	287.3	258	2	694	2974	1200		9.84
29344 EM	9039344	220	360	85	29	40.7	125	334.4	278.5	4	1608	5822	650	800	34.5
29444 EM	9039444	220	420	122	44	56.9	132	383.2	300	6	2870	9634	500	680	74.2
29248 EM	9039248	240	340	60	19	29.3	160	332	282	2.1	977	4077	1000		17.1
29348 EM	9039348	240	380	85	27	41.7	135	353.7	299	4	1700	6412	630	800	36.3
29448 EM	9039448	240	440	122	44	56.9	142	402	318	6	2978	10298	500	630	83
29252 EM	9039252	260	360	60	19	29.7	139	342.4	303	2.1	1050	4598	1000		18.5
29352 EM	9039352	260	420	95	32	47.5	148	393.1	325	5	2110	8050	550	710	51.5
29452 EM	9039452	260	480	132	48	64.7	154	440.8	343.5	6	3200	12375	450	630	106
29256 EM	9039256	280	380	60	19	29.5	150	362	323	2.1	1050	4598	900		19.5
29356 EM	9039356	280	440	95	32	46.3	158	412.5	346	5	2220	8767	550	710	54
29456 EM	9039456	280	520	145	52	67.6	166	476.1	373.5	6	4131	14645	430	560	137
29260 EM	9039260	300	420	73	21	35.8	162	399.8	350.5	3	1466	6488	710		31

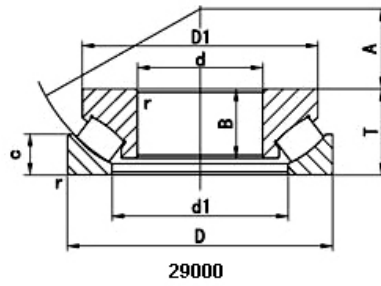

Bearing No.		Dimension (mm)									Load rating (KN)		Limit speed		Mass
New	Original	d	D	H	B	C	a	D1	d1	rsmin	Ca	Coa	grease	oil	(kg)
29360 EM	9039360	300	480	109	37	53.1	168	447.8	371.5	5	2682	10400	470	630	75.4
29460 EM	9039460	300	540	145	52	68.3	172	479.5	395	6	4250	15449	400	500	146
29264 EM	9039264	320	440	73	21	36	172	418.6	369.5	3	1521	6893		630	32.8
29364 EM	9039364	320	500	109	37	53	180	468	393	5	2833	11360	450	560	80
29464 EM	9039464	320	580	155	56	76.1	191	534.9	418	7.5	4917	18167	380	500	179
29268 EM	9039268	340	460	73	21	36.5	183	439.2	395	3	1570	7304		630	34.5
29368 EM	9039368	340	540	122	41	57.8	192	504	422	5	3373	13425	400	500	106
29468 EM	9039468	340	620	170	61	79.1	201	565.7	448.5	7.5	5504	20070	340	450	228
29272 EM	9039272	360	500	85	25	40.8	194	475.7	419	4	1989	9084		560	50.4
29372 EM	9039372	360	560	122	41	58.1	202	475.3	442.5	5	3442	13990		500	140
29472 EM	9039472	360	640	170	61	81.6	210	565.7	468.5	7.5	5682	21212		450	234
29276 EM	9039276	380	520	85	27	41.8	202	524.3	439	4	2002	9307		560	52.8
29376 EM	9039376	380	600	132	44	61.4	216	588.9	476	6	3962	16164		500	140
29476 EM	9039476	380	670	175	61	85.2	230	469.2	488.5	7.5	6025	22737		430	263
29280 EM	9039280	400	540	85	27	41.9	212	515.3	459	4	2065	9839		700	55.1
29380 EM	9039380	400	620	132	44	64.7	225	564.9	490	6	4040	16810		450	146
29480 EM	9039480	400	710	185	67	92.3	236	621.1	515.5	7.5	6757	25820		380	314
29284 EM	9039284	420	580	95	30	49.2	225	552.6	485	5	2536	12067		560	74.9
29384 EM	9039384	420	650	140	48	68	235	620	514.5	6	4434	18466		420	170
29484 EM	9039484	420	730	185	67	91.2	244	675.3	520	7.5	6969	27200		370	325
29288 EM	9039288	440	600	95	30	49.3	235	573.8	505	5	2618	12747		560	79
29388 EM	9039388	440	580	145	49	70.8	245	637.3	539	6	4757	20018		400	192
29488 EM	9039488	440	780	206	74	101.6	260	715.7	572	9.5	8073	31032		350	421
29292 EM	9039292	460	620	95	30	49.6	245	597.8	535	5	2644	13085		500	80.9
29392 EM	9039392	460	710	150	51	74.4	257	665.1	559.5	6	5205	22264		400	216
29492 EM	9039492	460	800	206	74	99.9	272	737.1	596.5	9.5	8325	32668		350	435
29296 EM	9039296	480	650	103	33	55	259	635	556	5	2982	14620		480	98
29396 EM	9039396	480	730	150	51	74.4	270	686	582	6	5214	22550		400	224
29496 EM	9039496	480	850	224	71	106.5	280	782.2	628.5	9.5	9419	36691		320	534.2
292/500 EM	90392/500	500	670	103	33	50.5	268	641	571.5	5	3012	14987		450	101
293/500 EM	90393/500	500	750	150	51	73.2	280	707.1	603	6	5322	23422		360	231
294/500 EM	90394/500	500	870	224	81	109.8	290	798.8	641	9.5	9520	40000		320	559
292/530 EM	90392/530	530	710	109	35	54	228	679.7	604.5	5	3356	16859		400	108
293/530 EM	90393/530	530	800	160	54	78.6	295	752.7	642	7.5	6057	26973		320	270
294/530 EM	90394/530	530	920	236	85	113.3	309	849.5	682.5	9.5	10703	42908		300	650
292/560 EM	90392/560	560	750	115	37	57.7	302	717.9	639	5	3100	8600		350	140
293/560 EM	90393/560	560	850	175	60	87	310	797	675	7.5	5790	29700		280	320
294/560 EM	90394/560	560	980	250	90	122.5	328	905.6	722.5	12	10210	47800		250	740
292/600 EM	90392/600	600	800	122	39	59.4	321	965.4	685.5	5	3420	20100		300	172
293/600 EM	90393/600	600	900	180	61	88	335	845.5	723.5	7.5	6350	32600		250	368
294/600 EM	90394/600	600	1030	258	110	136	347	1050	766	12	12730	52273		200	880
292/630 EM	90392/630	630	850	132	42	67.3	338	812.6	720	6	4770	24500		250	218
293/630 EM	90393/630	630	950	190	65	93.9	345	895.6	763.5	9.5	7070	37000		200	438
294/630 EM	90394/630	630	1090	280	100	136	365	1040	830	12	13700	58200		200	1000
293/670 EM	90393/670	670	1000	200	68	98.2	372	939.1	803	9.5	7720	40300		150	501
292/710 EM	90392/710	710	950	145	46	73.4	380	9095	810.5	6	4840	29400		150	261
293/710 EM	90393/710	710	1060	212	72	105.2	394	994.1	848.5	9.5	8570	45100		120	579
294/710 EM	90394/710	710	1220	308	113	150	415	1165	925	15	16800	71000		180	1500

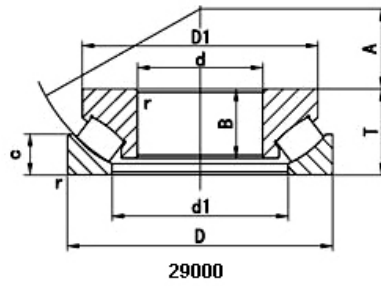

Bearing No.		Dimension (mm)									Load rating (KN)		Limit speed		Mass
New	Original	d	D	H	B	C	a	D1	d1	rsmin	Ca	Coa	grease	oil	(kg)
292/750 EM	90392/750	750	1000	150	48	76.8	406	958.6	854	6	5180	31900		130	130
293/750 EM	90393/750	750	1120	224	76	108	415	1061.3	917.5	9.5	9370	50600		100	696
294/750 EM	90394/750	750	1280	315	160	158	436	1152	972	15	17500	75000		150	1650
292/800 EM	90392/800	800	1060	155	50	79.2	426	1017.6	907.5	7.5	5620	35300		100	339
293/800 EM	90393/800	800	1180	230	78	116.1	440	1108	948	9.5	10110	54900		80	780
294/800 EM	90394/800	800	1360	335	121	162	445	1255	1034	15	16600	77500			1960
292/850 EM	90392/850	850	1120	160	51	82.9	453	1076.7	961	7.5	6080	38900		80	389
293/850 EM	90393/850	850	1250	243				1165	1021	12	12900	62000			972
294/850 EM	90394/850	850	1440	354				1325	1077	15	24000	110000		80	2350
292/900 EM	90392/900	900	1180	170	54	84.5	477	1132.2	1018.5	7.5	6590	42000		60	444
294/900 EM		900	1520	372				1405	1137	15					2 740
292/950 EM		950	1250	180				1190	1081	7.5					575
294/950 EM		950	1600	390				1475	1209	15					3 170
292/1000 EM		1 000	1320	190				1255	1139	9.5					688
294/1000 EM		1 000	1670	402				1540	1250	15					3 570
292/1060 EM		1 060	1400	206				1336,3	1211	9.5					844
294/1060 EM		1 060	1770	426				1630	1349	15					4 200
292/1120 EM		1 120	1460	206				1395	1272	9.5					887
292/1180 EM		1 180	1520	206				1455	1331	9.5					930