

IXIN's own factory covering 10000 square meters,120 workers,especially developing and manufacturing middle and large size thrust ball bearings,production is strictly conform to china GB/T307-1994 standard (ISO 492/DIN 620),all bearings adopt GCr15 (100Cr6,AISI 52100) refined bearing steel and 100% archieve ABEC-1 precision grade.

Welcome new and old customers visit us for mutual developping and cooperation.



### INDEX

Single direction thrust ball bearings

Double direction thrust ball bearings

### Description

**Structure:** Single direction and double direction available,cage:pressed steel,M machined brass cage for large type

**Accuracy:** P0 (ABEC-1)

**Material:** GCr15 (100Cr6),9Cr18 (440C), quench-hardness HRC60---65,Cage:pressed steel,Machined brass for large type

**Instruction:**



### Thrust ball bearings

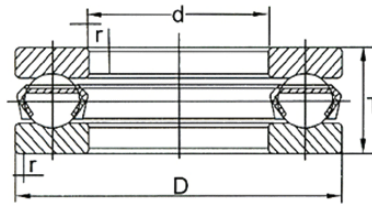

Bearing No.		Dimension (mm)				Load rating(KN)		Limiting speed		Mass
New	Original	d	D	T	rmin	Ca	Coa	Grease	Oil	(kg)
51100	8100	10	11	24	9	10	13.3	7000	9500	0.02
51200	8200	10	12	26	11	12.7	16.2	6000	8000	0.03
51101	8101	12	13	26	9	10.3	14.5	6700	9000	0.022
51201	8201	12	14	28	11	13.2	18.1	6000	8000	0.035
51102	8102	15	16	28	9	10.5	13.3	6300	8500	0.024
51202	8202	15	17	32	12	14.2	15.8	5300	7000	0.044
51202/YB2	8202K	15	15.2	32	12	14.2	15.8	5300	7000	0.045
51103	8103	17	18	30	9	10.8	13.4	6300	8500	0.024
51203	8203	17	19	35	12	17.2	26.1	5000	6700	0.053
51104	8104	20	21	35	10	13.4	18.6	5600	7500	0.037
51204	8204	20	22	40	14	22.3	35.6	4500	6000	0.08
51105	8105	25	26	42	11	17.4	27.6	4800	6300	0.06
51205	8205	25	25.2	47	15	27.8	47.5	4000	5300	0.112
51305	8305	25	27	52	18	35.7	52.3	3400	4500	0.18
51405	8405	25	27	60	24	55.5	85.5	2600	3600	0.34
51106	8106	30	32	47	11	18.1	31.8	4500	6000	0.07
51206	8206	30	32	52	16	28.1	45.1	3600	4800	0.137
51306	8306	30	32	60	21	42.8	62.2	2800	3800	0.252
51406	8406	30	32	70	28	72.7	119	2000	3000	0.53
51107	8107	35	37	52	12	21.2	38.2	4300	5600	0.084
51207	8207	35	35.2	62	18	39.2	63.7	3000	4000	0.22
51307	8307	35	37	68	24	55.4	83.6	2400	3400	0.39
51407	8407	35	37	80	32	87	148	1800	2600	0.82
51108	8108	40	42	60	13	26.9	47.5	3800	5000	0.12
51208	8208	40	42	68	19	47	93.1	2800	3800	0.3800
51308	8308	40	42	78	26	69.2	106	2000	3000	0.426
51408	8408	40	42	90	36	112	194	1700	2400	1.18
51109	8109	45	47	65	14	27	54.2	3400	4500	0.15
51109M	8109	45	47	65	14	31.6	108	3400	4500	0.16
51209	8209	45	47	73	20	47.8	76	2600	3600	0.32
51309	8309	45	47	85	28	75.8	133	1900	2800	0.665
51409	8409	45	47	100	39	141	228	1600	2200	1.64
51110	8110	50	52	70	14	27.1	59.9	3200	4300	0.4300
51210	8210	50	52	78	22	48.5	101	2400	3400	0.375
51310	8310	50	52	95	31	96.6	164	1800	2600	1
51410	8410	50	52	110	43	160	295	1500	2000	1.99
51111	8111	55	57	78	16	34.4	74.1	2800	3800	0.232
51211	8211	55	57	90	25	67.6	127	1900	2800	0.61

## Thrust ball bearings

Bearing No.		Dimension (mm)				Load rating(KN)		Limiting speed		Mass	Mass
New	Original	d	D	T	rmin	Ca	Coa	Grease	Oil	(kg)	
51311	8311	55	57	105	35	114.5	198	1600	2200	1.34	
51411	8411	55	57	120	48	183	342	1300	1800	2.6	
51112	8112	60	62	85	17	40.3	85.5	2600	3600	0.29	
51112	8212	60	62	95	26	73.6	133	1900	2800	0.69	
51312	8312	60	62	110	35	118	198	1600	2200	1.43	
51412	8412	60	62	130	51	201	380	1100	1600	3.3	
51113	8113	65	67	90	18	41.7	93.1	2400	3400	0.34	
51213	8213	65	67	100	27	74.9	143	1800	2600	0.77	
51313	8313	65	67	115	36	116	209	1500	2000	1.57	
51413	8413	65	68	140	56	217	428	1000	1500	4.2	
51114	8114	70	72	95	18	42	98.8	2400	3400	0.36	
51214	8214	70	72	105	27	73.6	152	1800	2600	0.81	
51314	8314	70	72	125	40	148	285	1400	1900	1.932	
51414	8414	70	73	150	60	257	475	950	1400	5.18	
51115	8115	75	77	100	19	44	130	2200	3200	0.42	
51215	8215	75	77	110	27	74.9	162	1700	2400	0.86	
51315	8315	75	77	135	44	163	342	1200	1700	2.7	
51415	8415	75	78	160	65	269	532	900	1300	6.97	
51116	8116	80	82	105	19	48.8	133	2000	3000	0.43	
51216	8216	80	82	115	28	83.8	181	1700	2400	0.95	
51316	8316	80	82	140	44	178	342	1200	1700	2.58	
51416	8416	80	83	170	68	292	589	850	1200	7.11	
51117	8117	85	87	110	19	49.2	143	2000	3000	0.46	
51217	8217	85	88	125	31	103	238	1600	2200	1.3	
51317	8317	85	88	150	49	209	404	1100	1600	3.7	
51417	8417	85	88	180	72	318	646	850	1200	9.5	
51118	8118	90	92	120	22	65.1	181	1800	2600	0.636	
51218	8118	90	93	135	35	125	285	1500	2000	1.77	
51318M	8318	90	93	155	50	221	379	1000	1500	4.21	
51418	8418	90	93	190	77	327	713	800	1100	11.2	
51120	8120	100	102	135	25	85.1	257	1700	2400	1	
51220M	8220	100	103	150	38	149	323	1300	1800	2.51	
51320M	8320	100	103	170	55	263	478	950	1400	5.46	
51420	8420	100	103	210	85	399	917	700	950	14.9	
51122	8122	110	112	145	25	87.2	276	1600	2200	1.08	
51222	8222	110	113	160	38	139	342	1200	1700	2.6	
51322	8322	110	113	190	63	280	684	850	1200	7.9	
51422	8422	110	113	230	95	415	1083	630	850	20	
51124	8124	120	122	155	25	87.1	295	1600	2200	1.16	
51224	8224	120	123	170	39	136	380	1100	1600	2.9	
51324	8324	120	123	210	70	330	869	800	1100	9.75	
51126	8126	130	132	170	30	109	371	1400	1900	1.87	
51226	8226	130	133	190	45	186	513	950	1400	4.2	
51326	8326	130	134	225	75	358	1007	750	1000	13.3	
51426	8426	130	134	270	110	490	1520	560	750	32	
51128	8128	140	142	180	31	111	380	1300	1800	2.1	
51228	8228	140	143	200	46	191	542	950	1400	4.5	

## Thrust ball bearings

Bearing No.		Dimension (mm)				Load rating(KN)		Limiting speed		Mass
New	Original	d	D	T	rmin	Ca	Coa	Grease	Oil	(kg)
51328	8328	140	144	240	80	396	1159	700	950	15.9
51428	8428	140	144	280	112	494	1520	500	700	32.2
51130	8130	150	152	190	31	112	380	1200	1700	2.2
51230	8230	150	153	215	5	244	698	900	1300	5.8
51330	8330	150	154	250	80	407	1226	670	900	16.7
51132	8132	160	162	200	31	112	404	1200	1700	2.3
51232	8232	160	163	225	51	244	741	850	1200	6.7
51330	8332	160	164	270	87	463	1425	630	850	21.5
51134	8134	170	172	215	34	137	475	1100	1600	3.3
51234	8234	170	173	240	55	280	884	800	1100	8.3
51334	8334	170	174	280	87	445	1520	600	800	22.5
51136	8136	180	183	225	34	135	504	1000	1500	3.5
51236	8236	180	183	250	56	294	950	800	1100	8.08
51336	8336	180	184	300	95	494	1738	560	750	28.7
51152	8152	260	263	320	45	218	856	750	1000	7.96
51252	8252	260	264	360	79	450	1900	560	750	24.8
51160	8160	300	380	62	2	346	1520	630	850	17.5
51260	8260		420	95	3	575	2613	480	630	42.5
51164	8164	320	400	63	2	352	16115	600	800	18.8
51264	8264		440	95	3	543	2565	450	600	43
51168	8168	340	420	94	2	358	1710	600	800	19.8
51268	8268		460	96	3	545	2755	450	600	45
51368	8368		540	160	5	948	4332	200	250	142
51172	8172	360	440	65	2	371	1805	560	750	21.1
51272	8272		500	110	4	704	3610	400	530	69.2
51180	8180	400	480	65	2	383	2014	530	700	23
51280	8280		540	112	4	680	3773	250	380	74.5
51184	8184	420	500	65	2	390	2090	530	700	24.2
51784	8784		550	80	5	463	2574	500	650	53.6
51188	8188	440	540	80	2.1	501	2850	450	600	42
59188/YB2	9008188		540	60	2.1	360	2112	360	500	28.2
51288	8288		600	130	5	622	3530	320	470	109
51192	8192	460	560	80	2.1	501	2850	450	600	41.7
51292	8292		620	130	5	654	3962	200	300	114
51196	8196	480	580	80	2.1	513	2898	430	560	42.5
51396	8396		730	195	6	1065	6886	230	3300	308
511/500	81/500	500	600	80	2.1	525	3183	430	560	45.7
512/500	81/500		670	135	5	864	5443	250	300	137
593/500	90083/500		750	150	6	950	6320	180	220	228
511/530	81/530	530	640	85	3	518	3310	400	530	55.8
590/560	90089/560	560	610	30	1.1	128	960	560	800	9.55
591/600	90081/600	600	710	67	3	630	4275	380	500	50.1
512/630	82/630	630	850	175	6	1124	7041	100	160	243
510/670	10089/670	670	730	45	1.5	284	2160	380	530	20.5
511/670	81/670		800	105	4	728	4420	160	240	92.2
572/710	70082/710	710	950	109	6	787	980	150	220	199
592/710	90082/710		950	145	6	1025	1296	150	220	284

## Thrust ball bearings

Bearing No.		Dimension (mm)				Load rating(KN)		Limiting speed		Mass
New	Original	d	D	T	rmin	Ca	Coa	Grease	Oil	(kg)
591/750	97081/750	750	900	90	4	810	6210	160	240	100
517/780	87/780	780	930	100	3.5	800	6069	140	200	129
591/800	90081/800	800	950	90	4	800	6330	140	200	123
591/850	90081/850	850	1000	90	4	800	6500	130	190	115
591/950	90081/950	950	1120	103	5	852	6600	120	180	170
591/1000	90081/1000	1000	1180	109	5	930	6800	120	180	200

## Double direction thrust ball bearings

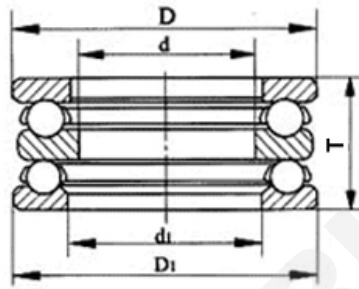

Bearing No.		Dimension (mm)						Shoulder dimension (mm)				Load rating (KN)		Limiting speed		Mass	
New	Original	d	D	T	T1	D1	D1	rsmín	r1smín	da	DA	Ca	Coa	A	grease	oil	(kg)
52205	38205	20	47	28	7	47	27	0.6	0.3	25	34	27.8	50.5	0.013	3400	4800	0.21
52305	38305	20	52	34	8	52	27	1	0.3	25	36	35.5	61.5	0.021	3000	4300	0.32
52406	38406	20	70	52	12	70	32	1	0.6	30	46	72.5	125	0.082	1900	3000	0.97
52206	38206	25	52	29	7	52	32	0.6	0.3	30	39	28	54.2	0.016	3200	4500	0.24
52306	38306	25	60	38	9	60	32	1	0.3	30	42	42.8	78.5	0.033	2400	3600	0.47
52407	38407	25	80	59	14	80	37	1.1	0.6	35	53	86.8	155	0.13	1700	2600	1.41
52207	38207	30	62	34	8	62	37	1	0.3	35	46	39.2	78.2	0.033	2800	4000	0.41
52208	38208	30	68	36	9	68	42	1	0.6	40	51	47	98.2	0.05	2400	3600	0.53
52307	38307	30	68	44	10	68	37	1	0.3	35	48	55.2	105	0.059	2000	3200	0.68
52408	38408	30	90	65	15	90	42	1.1	0.6	40	60	112	205	0.22	1500	2200	1.94
52209	38209	35	73	37	9	73	47	1	0.6	45	56	47.8	105	0.059	2200	3400	0.59
52309	38309	35	85	52	12	85	47	1	0.6	45	61	75.8	150	0.13	1700	2600	1.25
52409	38409	35	100	72	17	100	47	1.1	0.6	45	67	140	262	0.36	1400	2000	2.64
52210	38210	40	78	39	9	78	52	1	0.6	50	61	48.5	112	0.068	2000	3200	0.69
52310	38310	40	95	58	14	95	52	1.1	0.6	50	68	96.5	202	0.21	1600	2400	1.76
52410	38410	40	110	78	18	110	52	1.5	0.6	50	74	160	302	0.5	1300	1900	3.4
52211	38211	45	90	45	10	90	57	1	0.6	55	69	67.5	158	0.13	1900	3000	1.17
52311	38311	45	105	64	15	105	57	1.1	0.6	55	75	115	242	0.31	1500	2200	2.38
52411	38411	45	120	87	20	120	57	1.5	0.6	55	81	182	355	0.68	1100	1700	4.54
52212	38212	50	95	46	10	95	62	1	0.6	60	74	73.5	178	0.16	1800	2800	1.21
52312	38312	50	110	64	15	110	62	1.1	0.6	60	80	118	262	0.35	1400	2000	2.54
52412	38412	50	130	93	21	130	62	1.5	0.6	60	88	200	395	0.88	1000	1600	5.058
52413	38413	50	140	101	23	140	68	2	1	65	95	215	448	1.14	900	1400	7.07

## Thrust ball bearings

Bearing No.		Dimension (mm)					Shoulder dimension (mm)				Load rating (KN)			Limiting speed		Mass	
New	Original	d	D	T	T1	D1	D1	rsm	r1sm	da	DA	Ca	Coa	A	grease	oil	(kg)
52213	38213	55	100	47	10	100	67	1	0.6	65	79	74.8	188	0.18	1700	2600	1.32
52214	38214	55	105	47	10	105	72	1	1	70	84	73.5	188	0.19	1600	2400	1.42
52313	38313	55	115	65	15	115	67	1.1	0.6	65	85	115	262	0.38	1300	1900	2.72
52314	38314	55	125	72	16	125	72	1.1	1	70	92	148	340	0.6	1200	1800	3.64
52414	38414	55	150	107	24	150	73	2	1	70	102	255	560	1.71	850	1300	8.71
52215	38215	60	110	47	10	110	77	1	1	75	89	74.8	198	0.21	1500	2200	1.5
52315	38315	60	135	79	18	135	77	1.5	1	75	99	162	380	0.77	1100	1700	4.72
52415	38415	60	160	115	26	160	78	2	1	75	110	268	615	2	800	1200	10.7
52216	38216	65	115	48	10	115	82	1	1	80	94	83.8	222	0.27	1400	2000	1.63
52316	38316	65	140	79	18	140	82	1.5	1	80	104	160	380	0.81	1000	1600	4.92
52417	38417	65	180	128	29	179.5	88	2.1	1.1	85	124	318	782	3.24	700	1000	14.8
52217	38217	70	125	55	12	125	88	1	1	85	109	102	280	0.41	1300	1900	2.27
52317	38317	70	150	87	19	150	88	1.5	1	85	114	208	495	1.28	950	1500	6.26
52418	38418	70	190	135	30	189.5	93	2.1	1.1	90	131	325	825	3.71	670	950	17.3
52218	38218	75	135	62	14	135	93	1.1	1	90	108	115	315	0.52	1200	1800	3.05
52318	38318	75	155	88	19	155	93	1.5	1	90	116	205	495	1.34	900	1400	6.56
52420	38420	80	210	150	33	209.5	103	3	1.1	100	145	400	1080	6.17	600	850	23.5
52220	38220	85	150	67	15	150	103	1.1	1	100	120	132	375	0.75	1100	1700	4.03
52320	38320	85	170	97	21	170	103	1.5	1	100	128	235	595	1.88	800	1200	8.62
52422	38422	90	230	166	37	229	113	3	1.1	110	159	490	1390	10.4	530	750	33
52222	38222	95	160	67	15	160	113	1.1	1	110	130	138	412	0.89	1000	1600	4.38
52322	38322	95	190	110	24	189.5	113	2	1	110	142	278	755	2.97	700	1100	12.4
52224	38224	100	170	68	15	170	123	1.1	1.1	120	140	135	412	0.96	950	1500	4.82
52324	38324	100	210	123	27	209.5	123	2.1	1.1	120	157	330	945	4.58	670	950	17.1
52426	38426	100	270	192	42	269	134	4	2	130	188	630	2010	21.1	430	600	55
52226	38226	110	190	80	18	189.5	133	1.5	1.1	130	154	188	575	1.75	900	1400	7.36
52326	38326	110	225	130	30	224	134	2.1	1.1	130	169	358	1070	5.91	600	850	20.8
52428	38428	110	280	196	44	279	144	4	2	140	198	630	2010	22.2	400	560	61.2
52228	38228	120	200	81	18	199.5	143	1.5	1.1	140	164	190	598	1.96	850	1300	7.8
52328	38328	120	240	140	31	239	144	2.1	1.1	140	181	395	1230	7.84	560	800	25
52430	38430	120	300	209	46	299	154	4	2	150	212	670	2240	27.9	380	530	68.1
52230	38230	130	215	89	20	214.5	153	1.5	1.1	150	176	242	768	3.06	800	1200	10.3
52330	38330	130	250	140	31	249	154	2.1	1.1	150	191	405	1310	8.8	530	750	26.4
52232	38232	140	225	90	20	224.5	163	1.5	1.1	160	186	240	768	3.23	750	1100	10.9
52332	38332	140	270	153	33	269	164	3	1.1	160	205	470	1570	12.8	500	700	33.6
52234	38234	150	240	97	21	239.5	173	1.5	1.1	170	198	280	915	4.48	700	1000	13.4
52236	38236	150	250	98	21	249	183	1.5	2	180	208	285	958	4.91	670	950	14.6
52334	38334	150	280	153	33	279	174	3	1.1	170	215	470	1580	13.8	480	670	15
52336	38336	150	300	165	37	299	184	3	2	180	229	518	1820	17.9	430	600	49
52238	38238	160	270	109	24	269	194	2	2	190	222	328	1160	6.97	630	900	19.5
52240	38240	170	280	109	24	279	204	2	2	200	232	332	1210	7.59	600	850	20.4